

Product Presentation

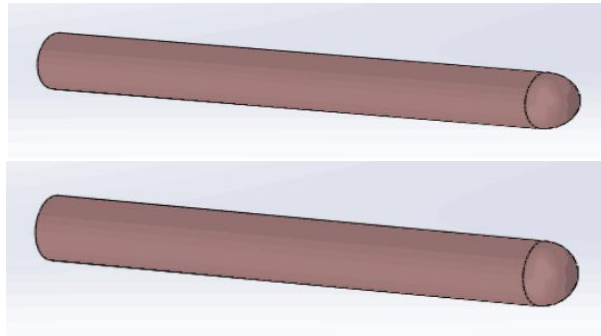

Application

Used to determine whether the openings or pores on the children bed will cause children finger fall into or not. This kit contains a 5.33mm diameter rod and a 9.53mm diameter rod.

Standards

ASTM F1821 section 5.8.; 16CFR PART 1217

Key Specification

Model	GT-MF 03	
Material	Stainless steel	
Feeler rod diameter	5.33mm	9.53mm
Insertion edge radius	2.67mm	4.77mm
Length	70mm	